

2.9L

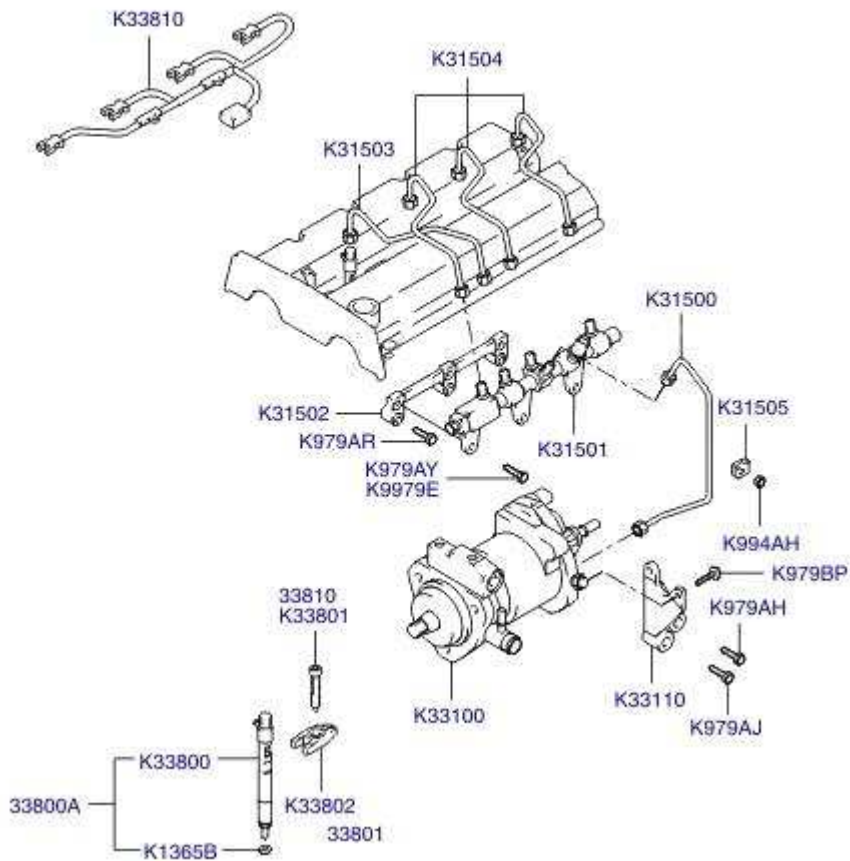

Article	Part No.	Description
BOLT	11233-06163	D4BH(4D56 TCI); FUEL INJ-ELECTRONIC TYPE
BOLT	11233-08163	D4BH(4D56 TCI); FUEL INJ-ELECTRONIC TYPE
BOLT	11290-08163	D4BH(4D56 TCI); FUEL INJ-ELECTRONIC TYPE
BOLT	11401-10163	D4BH(4D56 TCI); FUEL INJ-ELECTRONIC TYPE
BOLT	11403-08163	D4BH(4D56 TCI); FUEL INJ-ELECTRONIC TYPE
NUT	13100-08003	D4BH(4D56 TCI); FUEL INJ-ELECTRONIC TYPE
WASHER-SPRING	13602-08003	D4BH(4D56 TCI); FUEL INJ-ELECTRONIC TYPE
PIPE-INJECTION NO.1	31411-42000	D4BH(4D56 TCI); FUEL INJ-ELECTRONIC TYPE
PIPE-INJECTION NO.2	31412-42000	D4BH(4D56 TCI); FUEL INJ-ELECTRONIC TYPE
PIPE-INJECTION NO.3	31413-42000	D4BH(4D56 TCI); FUEL INJ-ELECTRONIC TYPE
PIPE-INJECTION NO.4	31414-42000	D4BH(4D56 TCI); FUEL INJ-ELECTRONIC TYPE
CLAMP(A)	31441-42000	D4BH(4D56 TCI); FUEL INJ-ELECTRONIC TYPE
CLAMP"A"ASSY	31441-42320	D4BH(4D56 TCI); FUEL INJ-ELECTRONIC TYPE
CLAMP"B"	31442-42000	D4BH(4D56 TCI); FUEL INJ-ELECTRONIC TYPE
CLAMP"C"	31443-42000	D4BH(4D56 TCI); FUEL INJ-ELECTRONIC TYPE
PUMP ASSY-FUEL INJECTION	33105-42700	D4BH(4D56 TCI); FUEL INJ-ELECTRONIC TYPE
	33105-42700B	D4BH(4D56 TCI); FUEL INJ-ELECTRONIC TYPE
	33105-42700A	D4BH(4D56 TCI); FUEL INJ-ELECTRONIC TYPE
BRACKET-F/INJECTION PUMP	33113-42000	D4BH(4D56 TCI); FUEL INJ-ELECTRONIC TYPE
WASHER	33134-42000	D4BH(4D56 TCI); FUEL INJ-ELECTRONIC TYPE

NUT	33131-42000	D4BH(4D56 TCI); FUEL INJ-ELECTRONIC TYPE
INSULATOR-FUEL INJECTION PUMP	33152-42100	D4BH(4D56 TCI); FUEL INJ-ELECTRONIC TYPE
NOZZLE & HOLDER ASSY-INJECTION	33800-42500	D4BH(4D56 TCI); FUEL INJ-ELECTRONIC TYPE
	33800-42510	D4BH(4D56 TCI); FUEL INJ-ELECTRONIC TYPE
INJECTOR ASSY-FUEL	33801-4X500	2900 CC; FUEL INJ-ELECTRONIC TYPE
	33801-4X810	2900 CC; FUEL INJ-ELECTRONIC TYPE
	33801-4X800	2900 CC; FUEL INJ-ELECTRONIC TYPE
GASKET-INJECTOR	33813-4X500	2900 CC; FUEL INJ-ELECTRONIC TYPE
CLIP-INJECTOR CONN.	33810-4X530	2900 CC; FUEL INJ-ELECTRONIC TYPE
GASKET-HOLDER	33813-42000	D4BH(4D56 TCI); FUEL INJ-ELECTRONIC TYPE
GASKET-NOZZLE	33814-42001	D4BH(4D56 TCI); FUEL INJ-ELECTRONIC TYPE
	33814-42000	D4BH(4D56 TCI); FUEL INJ-ELECTRONIC TYPE
BRKT-WIRING	91255-H1110	D4BH(4D56 TCI); FUEL INJ-ELECTRONIC TYPE
GASKET-NOZZLE	0SL01-13651	2900 CC; FUEL INJ-ELECTRONIC TYPE
PIPE ASSY-HPP	31500-4X520	2900 CC; FUEL INJ-ELECTRONIC TYPE
RAIL-COMMON	31500-4X700	2900 CC; FUEL INJ-ELECTRONIC TYPE
	31500-4X500	2900 CC; FUEL INJ-ELECTRONIC TYPE
BRKT-COMMON RAIL	31500-4X511	2900 CC; FUEL INJ-ELECTRONIC TYPE
PIPE ASSY-FUEL INJ 1	31500-4X530	2900 CC; FUEL INJ-ELECTRONIC TYPE
PIPE ASSY-FUEL INJ2 3 4	31500-4X540	2900 CC; FUEL INJ-ELECTRONIC TYPE
CLIP-PIPE HPP	31500-4X610	2900 CC; FUEL INJ-ELECTRONIC TYPE
PUMP-HIGH PRESSURE	33100-4X500	2900 CC; FUEL INJ-ELECTRONIC TYPE
	33100-4X700	2900 CC; FUEL INJ-ELECTRONIC TYPE
BRKT-HIGH PRESSURE PUMP	33110-4X510	2900 CC; FUEL INJ-ELECTRONIC TYPE
INJECTOR	33800-4X500	2900 CC; FUEL INJ-ELECTRONIC TYPE
	33800-4X800	2900 CC; FUEL INJ-ELECTRONIC TYPE
BOLT-INJECTOR CLAMP	33800-4X530	2900 CC; FUEL INJ-ELECTRONIC TYPE
CLAMP-INJECTOR	33800-4X570	2900 CC; FUEL INJ-ELECTRONIC TYPE
W/H ASSY-INJECTOR	33810-4X600	2900 CC; FUEL INJ-ELECTRONIC TYPE
BOLT	K9979-61035B	2900 CC; FUEL INJ-ELECTRONIC TYPE
BOLT	K9979-61050B	2900 CC; FUEL INJ-ELECTRONIC TYPE
BOLT	K9979-60845B	2900 CC; FUEL INJ-ELECTRONIC TYPE
BOLT	K9979-60830B	2900 CC; FUEL INJ-ELECTRONIC TYPE
BOLT	K9979-60820B	2900 CC; FUEL INJ-ELECTRONIC TYPE
NUT-FLANGE	K9994-00500B	2900 CC; FUEL INJ-ELECTRONIC TYPE
BOLT	K9979-60835B	2900 CC; FUEL INJ-ELECTRONIC TYPE